

6" IC LED Dedicated Cans



Project:	
Type:	
Catalog #:	



REMODEL APPLICATIONS

Designed for remodel applications and in ceilings with direct contact with insulation. Air tight construction provides reduced energy costs.

FEATURES

- Galvanized steel construction with removeable housing for easy access to the junction box
- Listed for through branch circuit wiring
- Pre-installed Real nail easily installs in regular and engineered lumber
- Adjustable bar hangers from 13⁵/₈" - 25" and can be repositioned 90° on plaster frame
- Contains one 1¹/₈", six 7⁸/₈" knockouts and four Romex pryouts with strain relief

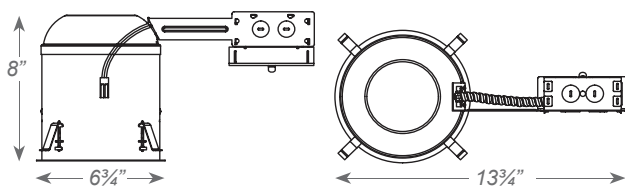

NEW CONSTRUCTION APPLICATIONS

Designed for new construction applications and in ceilings with direct contact with insulation. Air tight construction provides reduced energy costs.

FEATURES

- Galvanized steel construction with removeable housing for easy access to the junction box
- Listed for through branch circuit wiring
- Four remodel clips secure housing and accommodates 1/2" and 5/8" ceiling materials
- Housing adjusts from 5/8" to 1 3/8" to accommodate various ceiling thicknesses
- Contains one 1¹/₈", six 7⁸/₈" knockouts and four Romex pryouts with strain relief

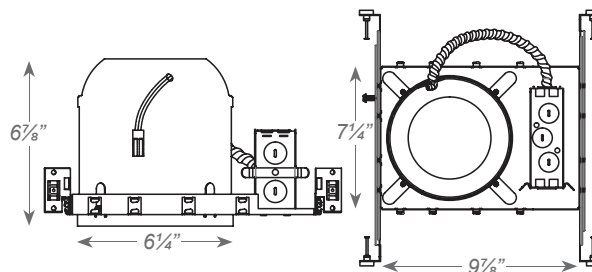

MODEL	DESCRIPTION
BL9ICLED-NND	6" IC LED Dedicated Can for New Construction
BL9ICLED-RND	6" IC LED Dedicated Can for Remodel applications